

COLUMN AND FOOTING DETAIL

TERRACE FLOOR LVL TO GROUND FLOOR LVL.	M25 : Fe500 : COVER = 40MM CONFINING ZONE = 557 MM	
UP TO GROUND FLOOR LVL.	RING @ JUNCTION	RING @ MIDDLE
	T8@75c/c	T8@100c/c
	6-T12	
ALONG SHORT DIR	T10@125c/c	
ALONG LONG DIR	T10@125c/c	
D,d	350	
FOOTING SIZE (M25)	1200 x 1350	
P.C.C SIZE (1:3:6)	1500 x 1650	
COLUMNS NO	C1,2,3,4,5,6,7,8 9,10,11,12	

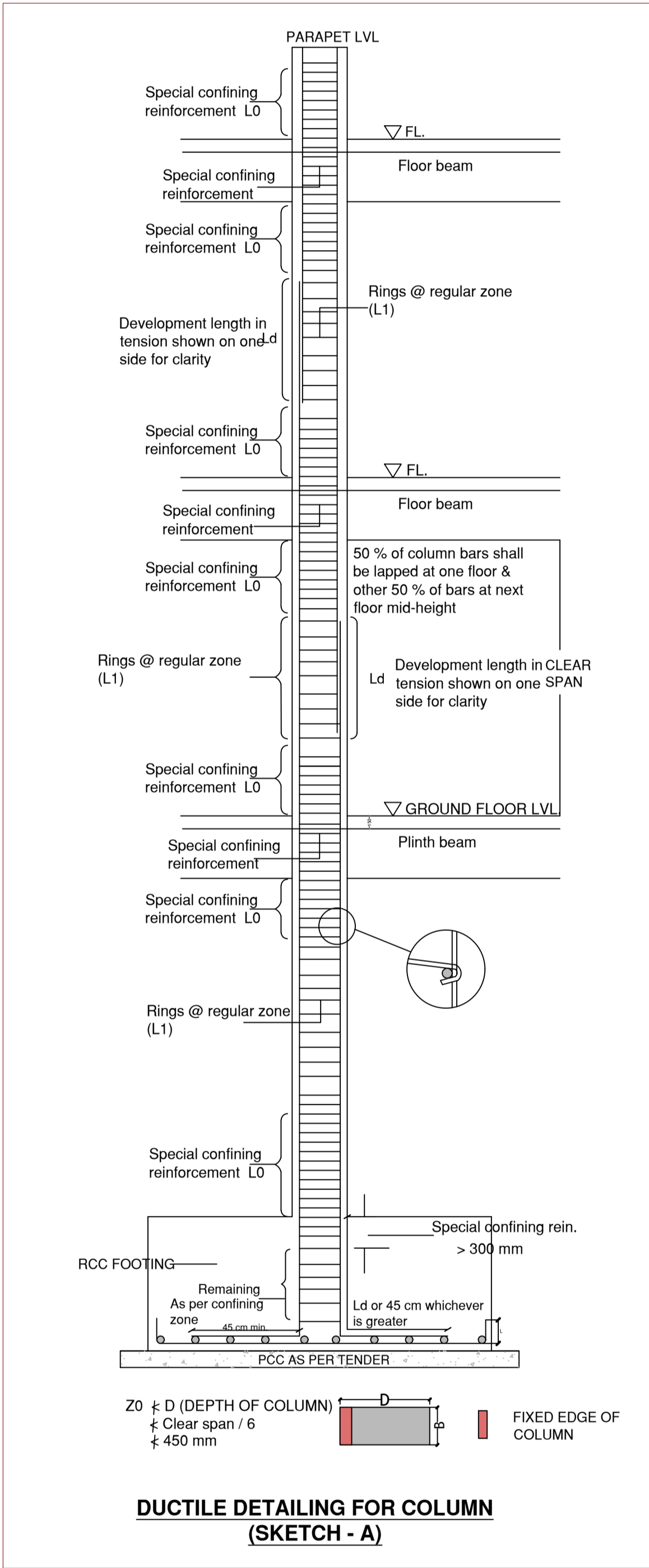

DRAWING TITLE
COLUMN AND FOOTING DETAIL

PROJECT NAME
CONSTRUCTION OF AANGANWADI
AT SURAT, DIST-SURAT.

ARCH-9 CONSULTANT
B-3, TIRUPATI SOC. NEAR OLD
BSNL OFFICE AJARAMAR CHOK
RANDER ROAD, SURAT
ph.no 8866 482861, 87600 0849
mail - arch9consultant@gmail.com

DATE:23-09-2023

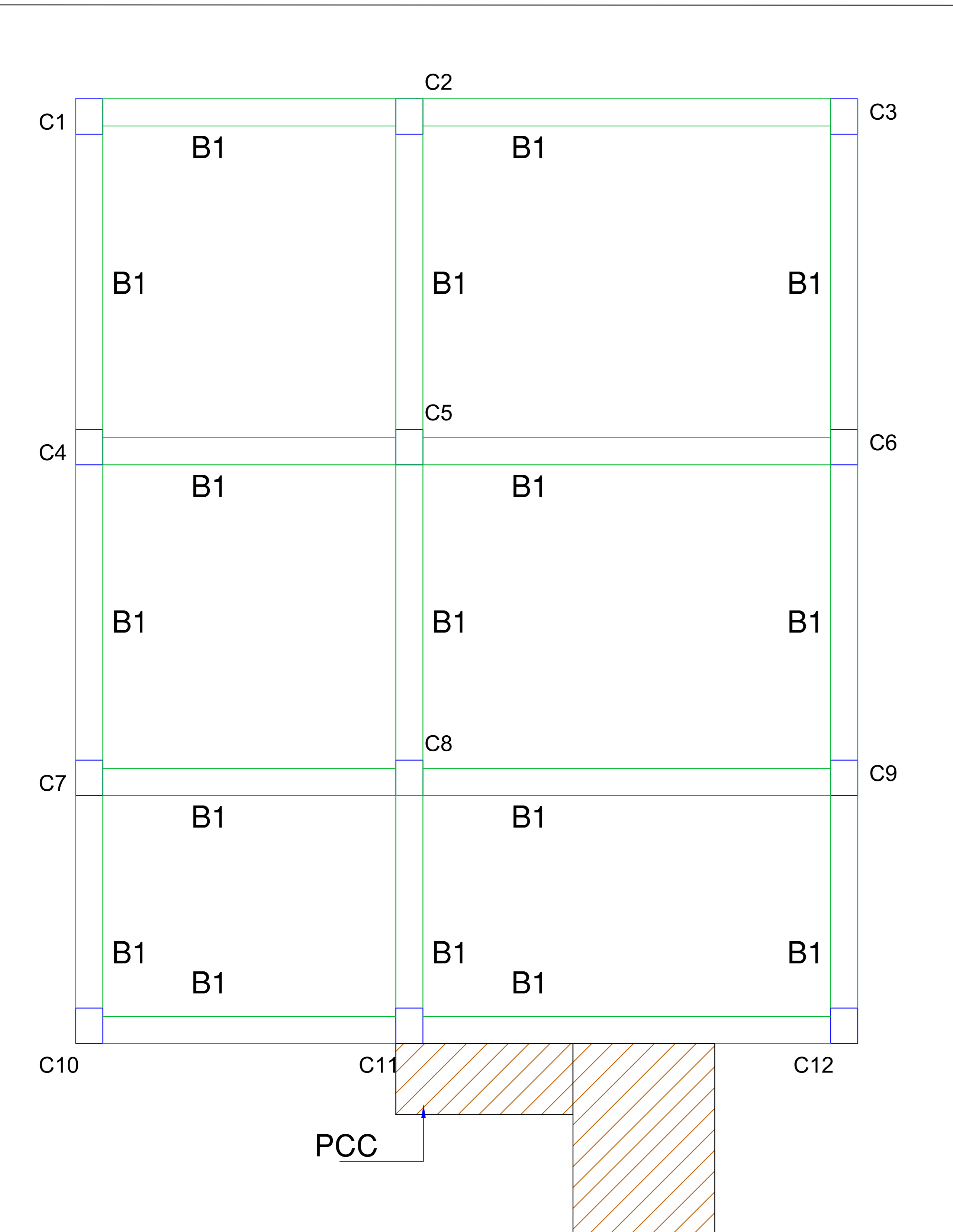

GROUND BEAM PLINTH BEAM SCHEDULE								
BEAM NO	SIZE IN MM	TOP STEEL		BOTTUM STEEL		STIRRUPS		REMARKS
		CONT.	BENT UP	CONT.	BENT UP	SUPPORT	CENTER	
GB1	230 X 300	2-12#	-	2-12#	1-12#	8# - 125 C/C	8# - 150C/C	-
PLINTH PCC 150 MM THICK M15 , 8#-300 C/C								

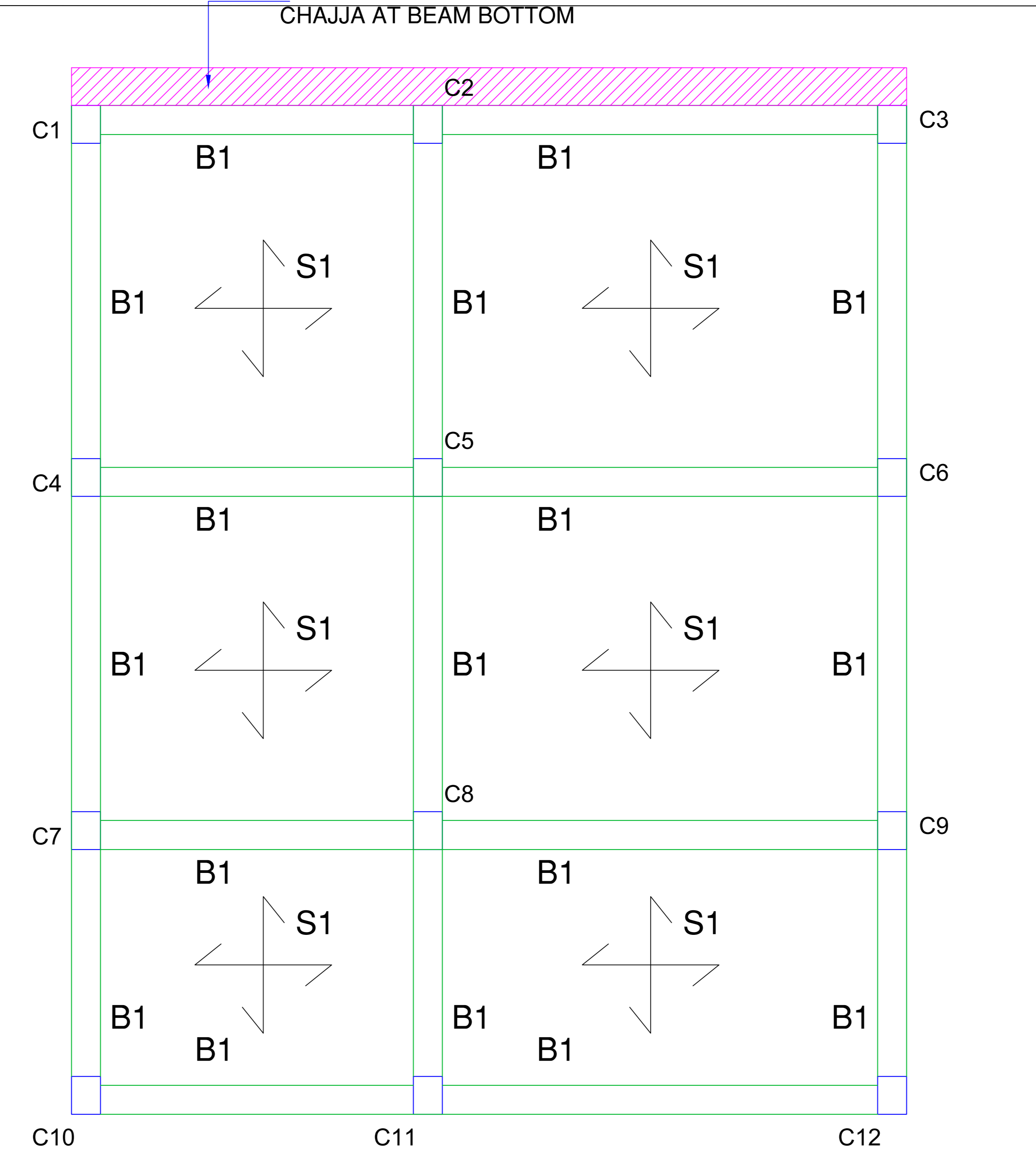

TERRACE SLAB BEAM SCHEDULE								
BEAM NO	SIZE IN MM	TOP STEEL		BOTTUM STEEL		STIRRUPS		REMARKS
		CONT.	BENT UP	CONT.	BENT UP	SUPPORT	CENTER	
B1	230 X 450	2-12#	-	2-12#	2-12#	8# - 125 C/C	8# - 150C/C	-
SLAB DETAIL								
SLAB NO	THICKNESS IN MM	MAIN STEEL		DISTR. STEEL		EXTRA TOP MAIN STEEL	EXTRA TOP DISTR. STEEL	REMARKS
S1	115	8# - 125MM C/C ALT. BENT		8# - 125MM C/C ALT. BENT		8# - 250MM C/C	8# - 250MM C/C	TWO WAY

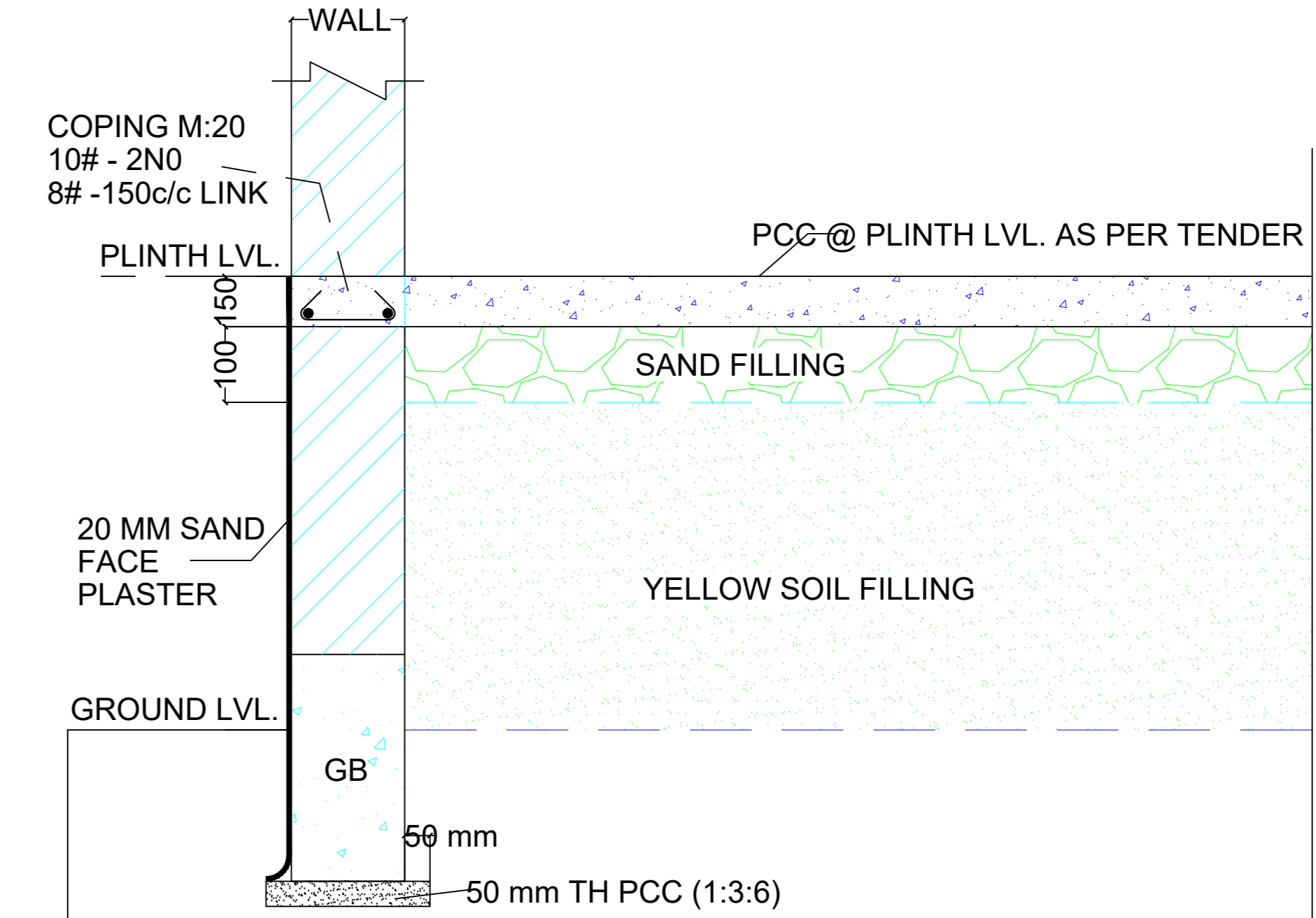

TYPICAL SECTION OF GB, PB, COPING, & PCC DETAIL

Note:
Beams can be taken either 'at ground lvl.' or 'at plinth lvl.' as per on site soil filling requirement.
Use 150mm th. layer of AS PER TENDER grade concrete for PCC at ground lvl./plinth lvl.
Use of nominal steel (8# @ 230 MM c/c) is advisable during PCC work.
PROJECTION DIMENSION SHOULD BE FOLLOW OR MATCH WITH ARCHITECTURAL DRAWING.